

Residential

3,650 Sqft - 10003 KENSINGTON PARKWAY,
KENSINGTON, MD 20895

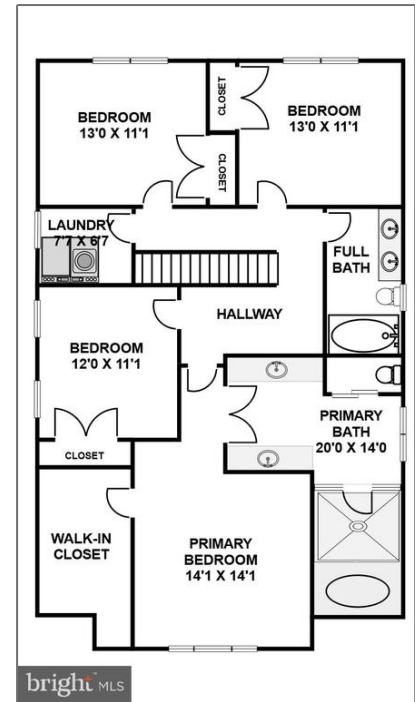
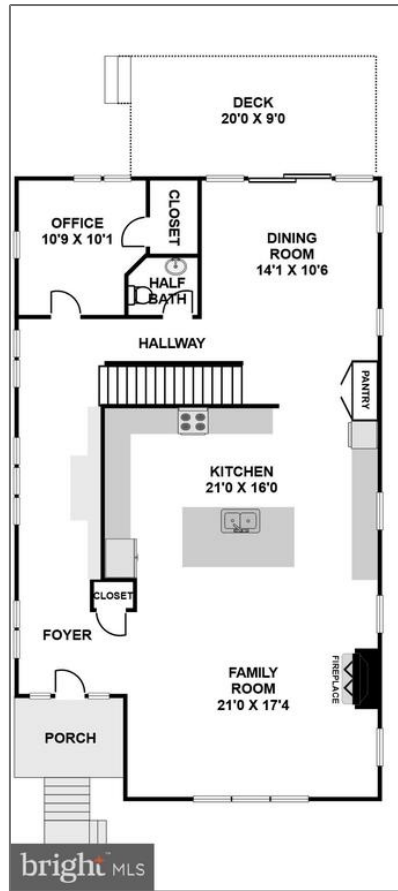

Basic Details

Property Type: **Residential**

Listing Type: **For Sale**

Price: **\$1,695,000**

Bedrooms: **5**

Bathrooms: **3**

Sqft: **3,650 Sqft**

Year Built: **2025**

Price Per SQFT: **\$640**

Status: **Active**

Agent Info



Amber Williams

☎ (703) 944-3884

✉ amber@sweethomesamerica.com
